

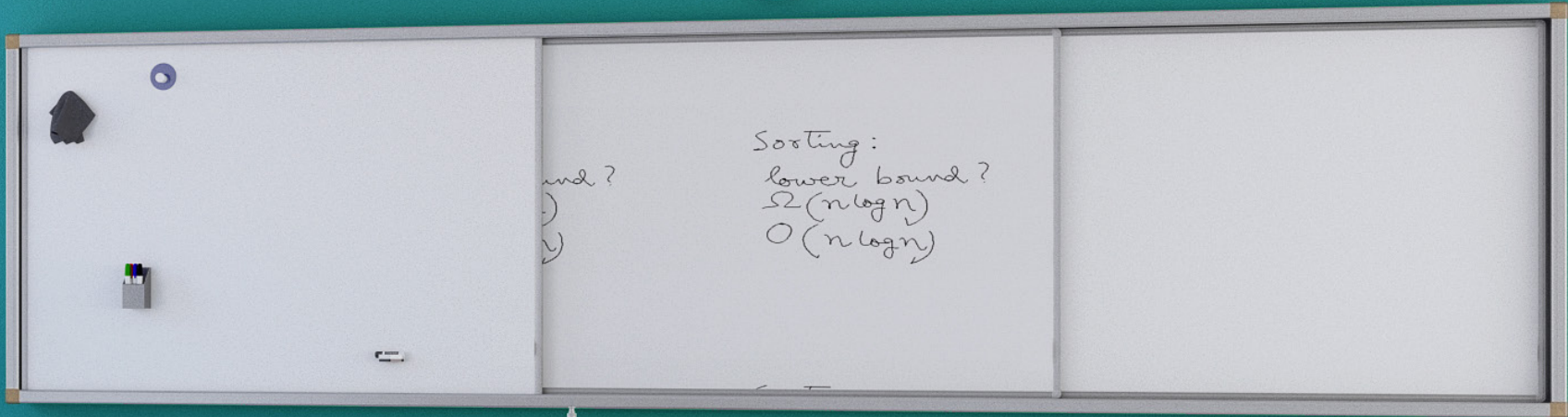

LEARNING
SURFACES

Horizontal Sliders



PRODUCT SPECIFICATIONS & FEATURES

HORIZONTAL SLIDERS

PRODUCT CODES	PRODUCT SIZE (Nominal)	# OF SLIDERS
LSHS12048-2T	10' x 4' x 0.625'	2
LSHS14448-2T	12' x 4' x 0.625'	2
LSHS16848-2T	14' x 4' x 0.625'	2
LSHS19248-2T	16' x 4' x 0.625'	2
LSHS12048-3T	10' x 4' x 0.625'	3
LSHS14448-3T	12' x 4' x 0.625'	3
LSHS16848-3T	14' x 4' x 0.625'	3
LSHS19248-3T	16' x 4' x 0.625'	3
LSHS12048-4T	10' x 4' x 0.67'	4
LSHS14448-4T	12' x 4' x 0.67'	4
LSHS16848-4T	14' x 4' x 0.67'	4
LSHS19248-4T	16' x 4' x 0.67'	4

HOW TO ORDER

LS HS 120 48 - 2T



BOARD HEIGHT & WIDTH HORIZONTAL SLIDER

	120" x 48"	144" x 48"	168" x 48"	192" x 48"
--	------------	------------	------------	------------

BOARD PROFILE

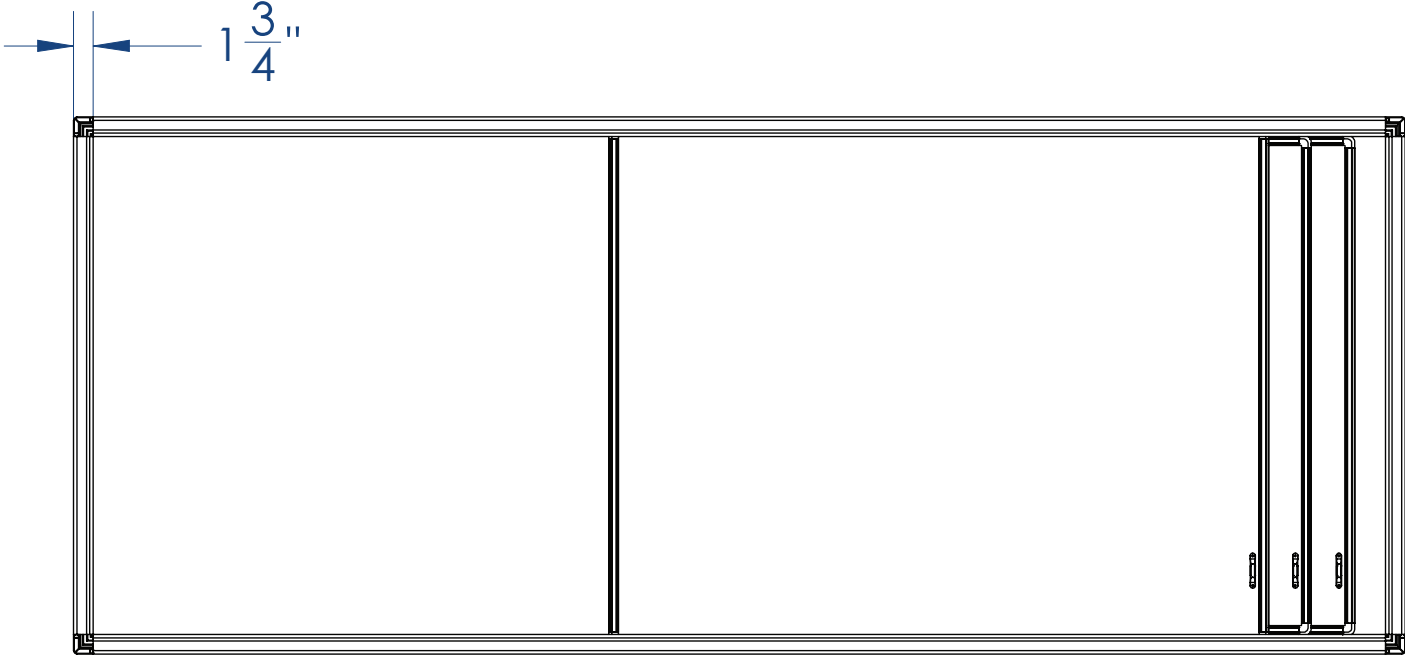

Line Drawing Front View

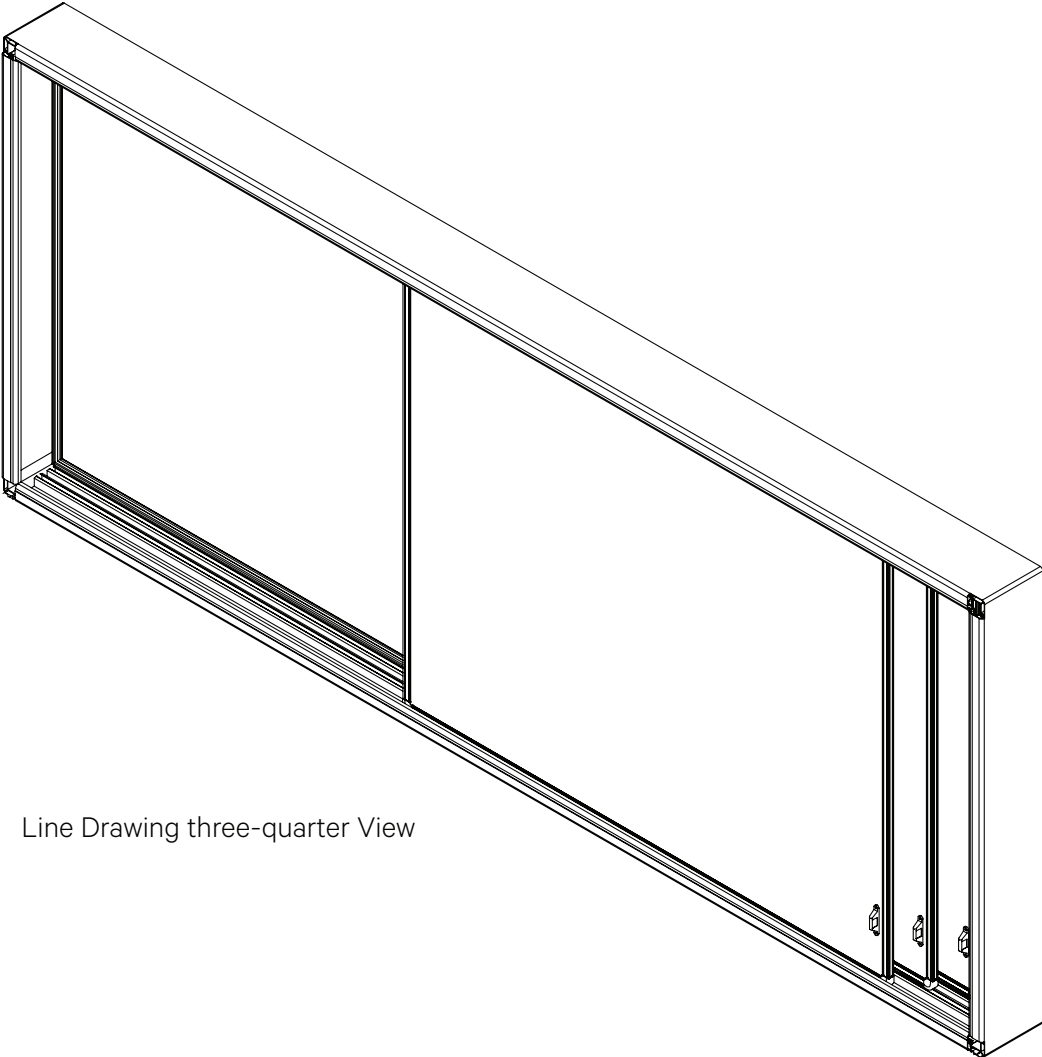

Line Drawing three-quarter View



WARRANTY INFORMATION

In the unlikely event that any Learning Surfaces product or component covered by the Learning Surfaces **Full Lifetime Warranty** should fail under normal use as a result of defective material or workmanship. Learning Surfaces shall repair or replace with comparable product (at Learning Surfaces's discretion), free of charge excluding installation labor.

Your Learning Surfaces Full Lifetime Warranty applies to All Learning Surfaces product lines, materials, and components. The warranty applies to Learning Surfaces products sold within the original purchaser. There are a few exclusions to the Learning Surfaces Full Lifetime Warranty. **These exclusions are:**

- Installation
- Electrical Components 1 year or manufacturers warranty whichever is greater.
- Color-fastness or matching of colors, wood grains, or textures occurring in wood, leather, or other materials that naturally exhibit inherent color variations.
- Customer's own materials (COM) selected by and used at the request of a user.
- Modifications or attachments to the product that are not approved by The LEARNING SURFACES Company and product failures resulting from such modifications or attachments.
- Product normal wear and tear, which is to be expected over the course of ownership.
- Products that were not installed, used, or maintained in accordance with product instructions and warnings.
- Products used for rental purposes.
- Damage caused by cleaning chemicals.
- Dye transfers caused by external contaminants (including clothing and accessory dyes such as those used on denim jeans) may migrate to lighter colors. This phenomenon is increased by humidity and temperature and is irreversible.



Having the correct tools can make all the difference in facilitating best-in-class student experience. Learning Surfaces is a presentation tool designed to support and facilitate effective communication. Learning Surfaces are made for demanding environments that require versatile, high-performance boards. This education board is an ideal communication solution built with busy teachers and students in mind. The boards are made for busy and boisterous classrooms, delivering long-lasting quality with environmental responsibility.

Draw, Write, Erase, Repeat.