

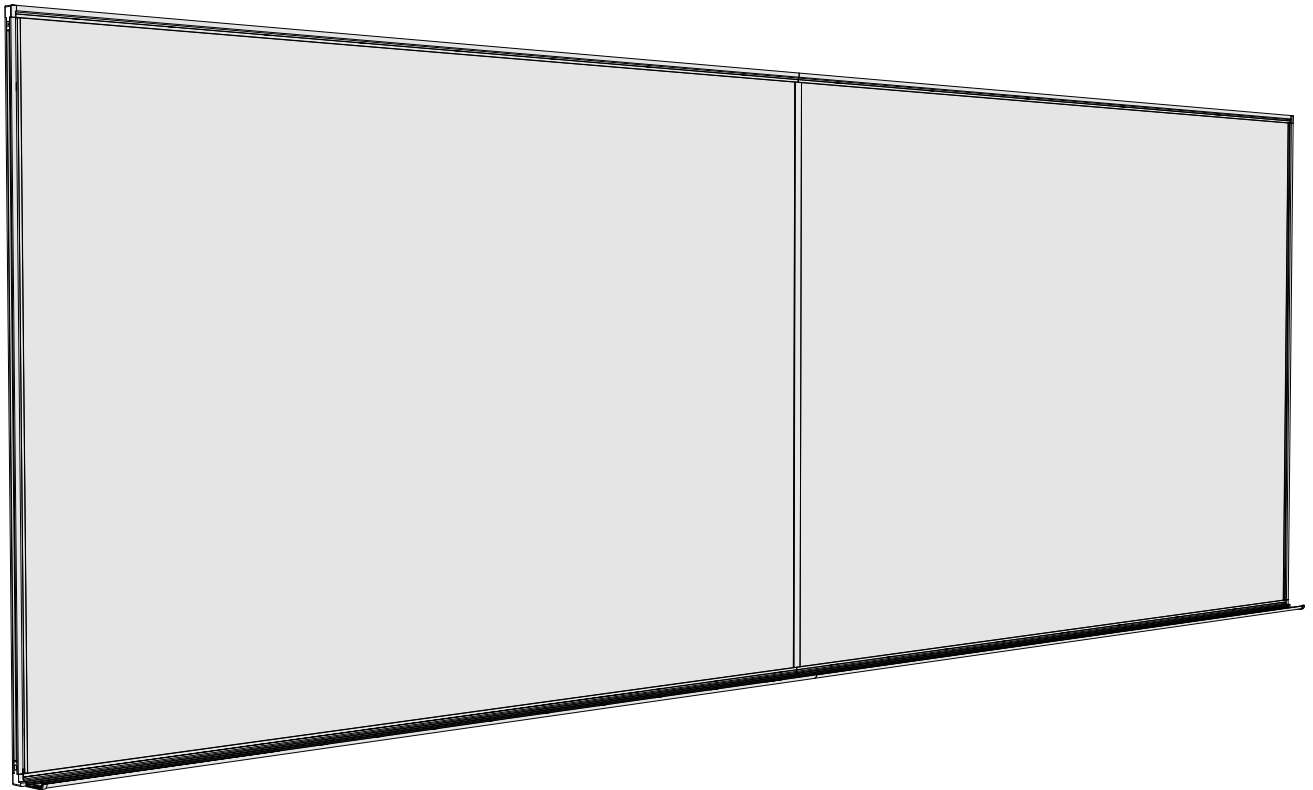

**LEARNING
SURFACES**

Combo Board

Assembly & Installation



Step 1

Mark two lines on the wall to match the full height of the Combo Board assembly. Install brackets into the wall.

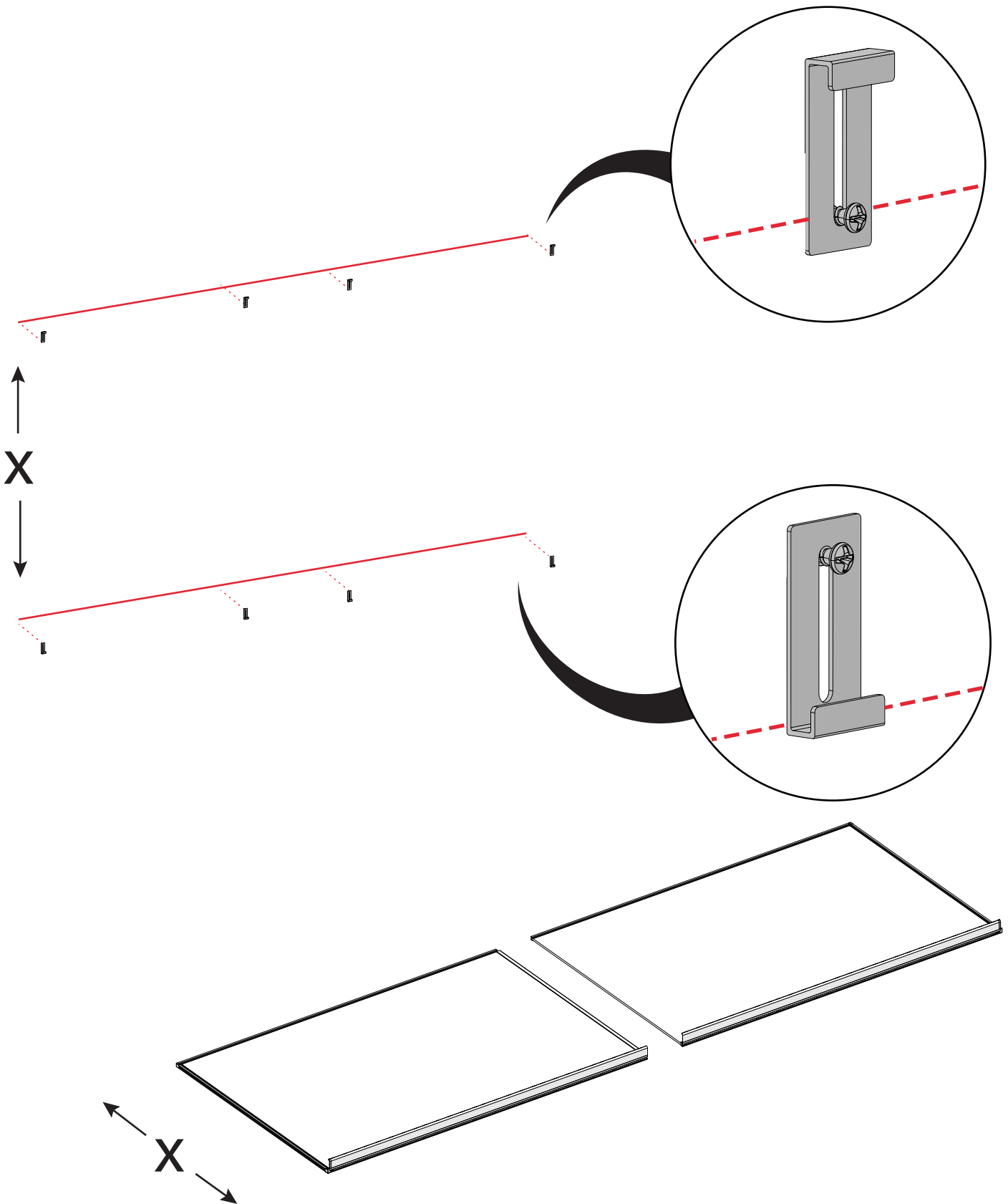

Step 2

Carefully lift the Combo Boards and place onto bottom hooks.

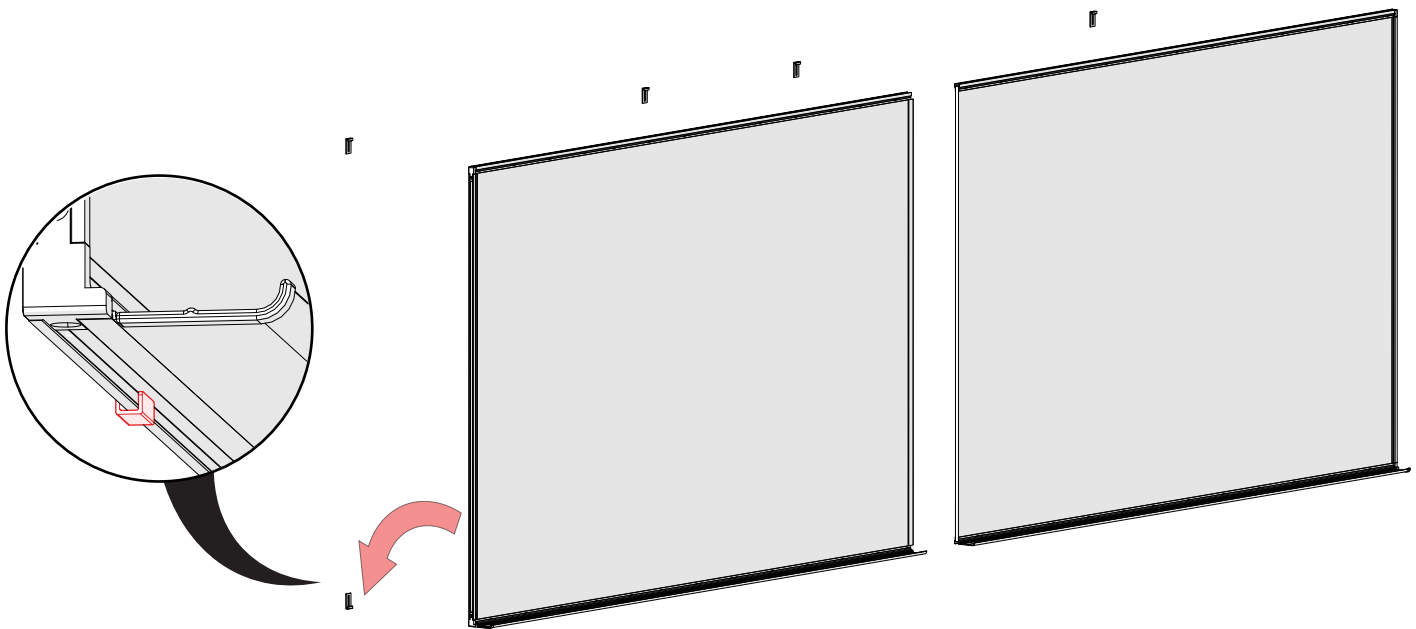

Step 3

Slide board together so that both are secured into the “I” molding in the center.

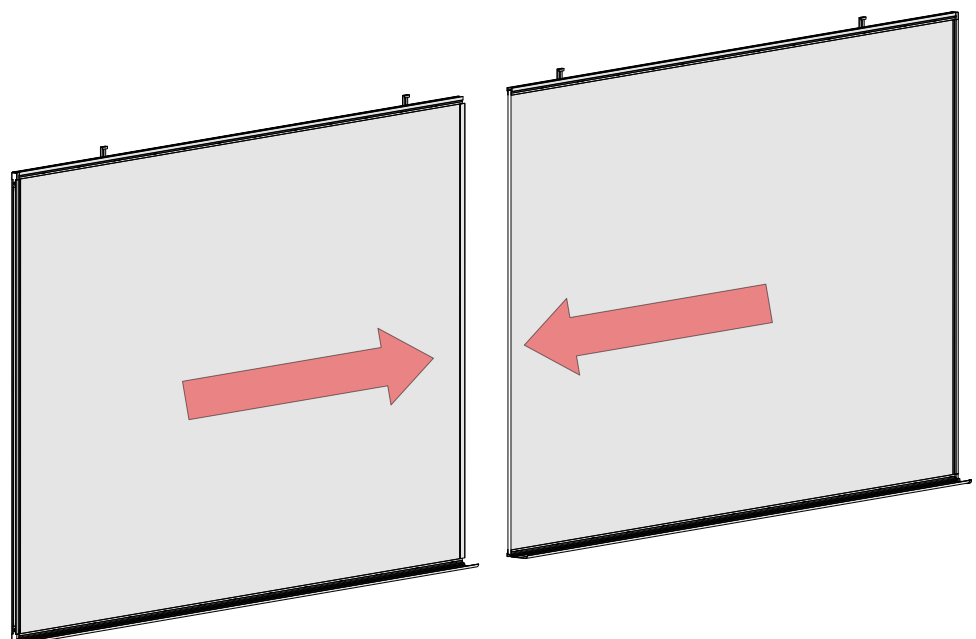

Step 4

Push down the top clips to secure the top frame of the Combo Board. This may require a rubber mallet.

